



CASTLE HILL & HILLS DISTRICT
AGRICULTURAL SOCIETY INC

TWILIGHT HORSE SHOW



Find us on
Facebook

Sunday 11th November 2018
RINGS 1-9 COMMENCE 11:00 am



Photo by Allira Fontana Photography www.allirafontana.com.au

PARKING & GATE FEE - \$15 PER FLOAT

Please park and set up in a considerate fashion so that as many people as possible can be accommodated.

PLEASE REMOVE MANURE FROM THE HARD SURFACE AREAS.

VISIT OUR WEBSITE

www.castlehillshow.com.au

General Enquiries to (02) 9634 2632 (message bank only) Email preferred.
horses@castlehillshow.com.au

Property Identification Code (PIC) IS NOW COMPULSORY.
ENTRIES WILL NOT be accepted without a valid PIC
WAIVERS MUST be LEGIBLE

NOTICE TO COMPETITORS

DISCLAIMER

The Castle Hill & Hills District Agricultural Society Inc Board and Committee Members, officials, volunteers, medical personnel, any person, promoters, sponsors, advertisers, owners and lessees of premises or sites WILL NOT accept liability for any accident, damage, injury or illness to horses, riders, handlers, beasts, ground spectators or any other person or property whatsoever AND all competitors WILL NOT be allowed to compete NOR enter the ring/arena unless a Waiver and Indemnity has been signed and a WRIST BAND is worn.

The Waiver and Indemnity is required to be signed on the day when purchasing ring passes. On receipt of the signed Waiver and Indemnity the WRIST BAND will be issued.

All Judges, Stewards and Officials will not allow riders or owners to enter the ring/arena unless this WRIST BAND is worn.

Drug Testing may be carried out at this show. Any breaches of the Rules & Regulations will be investigated by the Sub-Committee and offenders will be dealt with by the ASC Disputes/Disciplinary Sub-Committee.

***Love the Castle Hill Show?
.....help make it even better!!***

If you would like to be a part of the Horse Committee for the Castle Hill & Hills District Agricultural Society inc, please email: enquiries@castlehillshow.com.au

HELP NEEDED!!!!

This Show is run by only a FEW volunteers
Horse Shows at Castle Hill will not continue if we do not receive more help to run them.

If you can help as a Ring Steward, writing the program, typing up results or in any other way we would love to hear from you.

Please contact:

The Show office on 9634 2632 (message bank only) or email:
horses@castlehillshow.com.au

REGULATIONS OF THE CASTLE HILL & HILLS DISTRICT AGRICULTURAL SOCIETY INC

- Entries to the Castle Hill Twilight Show are "entry on the day". Tickets may be purchased from the Horse Office on the day of the show. No pre-entries to the Castle Hill Twilight Show will be accepted.
- Unless stated otherwise, entries in the Castle Hill Twilight Show are **\$5.00 per class**.
- Rings at the Castle Hill Twilight Show will run on a ticket system. Entry to ring classes will be granted in return for handing a ticket to the ring steward. **NO REFUNDS WILL BE GIVEN ON ANY ENTRY MONIES PAID**

WAIVER OF LIABILITY FORMS

- All competitors must sign the relevant waiver of liability forms. Each horse with which a competitor is involved must be listed together with the Property Identification Code (PIC) number for the property from which the horse came to the show.
- Entries will not be accepted from *any* competitor without a signed copy and a PIC number.

STALLIONS

- Stallions/ colts must be handled at all times by a person over the age of 17 years and must be led at all times with a bit. With the exception of where the Breed Society rules and regulations allow.
- Stallions are not eligible to compete in any class other than stallion classes and champion/ reserve classes where applicable.

GENERAL RULES

- **Horses must compete in either the Show Hunter or the Open Hack Ring, they may not compete in both**
- **Horses and Ponies competing in Breed classes must be registered with the relevant Breed Society for each Breed Ring**
- In all rings, the Judge's decision will be final.
- A Judge may ask a competitor to remove his horse from the ring if, in their opinion, the horse *or the exhibitor* is ill mannered or is unfit to compete.
- If competitors do not comply with the directions of Judges, stewards or event organisers, they may be disqualified from the event and asked to leave the Showground. In such a case the competitor may be disqualified from competing in any section or class of the Show or any future Show without refund.
- An approved safety Helmet must be worn at all times when mounted, incl. in the warm up arena.
- Competitors must be suitably attired. A rider or competitor who is not suitably attired may be precluded by the Stewards from competing in an event.
- If a Judge considers that any exhibit does not possess sufficient merit to deserve a prize, no award will be made. All ribbons awarded at the Judge's discretion.
- Champion & reserve ribbons may only be awarded where more than three horses enter in any section.
- All horses, galloways or ponies competing in height classes must compete at their correct height. Any horse holding a current official measuring certificate will compete at the said measurement and will not be re-measured on the day.
- All horses entered in Breed Classes must be registered with their relevant breed society. Registration papers and proof of membership must be produced if required by a Steward.

- Exhibitors or their agents, when called upon by the Stewards, must prove the correctness of their entries.
- Should competitors not be in the ring at the commencement of their class they may be deemed disqualified from competing in that class at the Steward's discretion
- The Castle Hill & Hills District Agricultural Society Inc reserves the right to alter the program or judges at any time.
- The Committee reserves the right to substitute a Judge where deemed necessary.

RESPONSIBILITY

- The Castle Hill & Hills District Agricultural Society inc accepts no responsibility for **any** accident, injury or damage to competitors, volunteers, helpers or spectators including damage to goods, property or vehicles. All persons attending this event do so at their own risk. It shall be the condition of each entry that each exhibitor shall hold the Castle Hill & Hills District Agricultural Society inc blameless, and indemnify it against any legal proceeding arising from any such accident.
- The Castle Hill & Hills District Agricultural Society inc will not, under any circumstances, hold itself responsible for any loss of exhibits, or any damage there to.
- Payment of entry to the Castle Hill Twilight Show will be taken as an acceptance of the Castle Hill & Hills District Agricultural Society inc Rules & Regulations.

ENTRY TO THE GROUNDS via SHOWGROUND Rd Gate Only

CAMPING AND STABLING FACILITIES

Camping and stabling facilities available
Enquiries must be made directly to the secretary at the Castle Hill and Hills District Agricultural Association on (02) 9634 2632

DEFINITIONS

Newcomer: a horse which has not competed under saddle (except for racing) at **any show prior to 1 January 2018**.

Novice: a rider who has not won a 1st place in a similar event in the Open Ring of a Hack, or Agricultural Show

Intermediate: a horse or rider who has not won a 1st, 2nd or 3rd place in a similar event at any Royal Show

Broodmare: a mare which has had a foal registered with a relevant society within the last three years or for which a pregnancy test certificate has been supplied or which has a foal at foot and can compete in Brood Mare Classes only.

Adult: a rider who has attained 17th Birthday prior to the first day of the show.

Child: a rider who has not attained 17th Birthday prior to the first day of the show.

District: a Pony, Galloway or Hack who is the property of the exhibitor who must reside within the Hills Shire or Hornsby Shires.

Consolation: classes for horse or riders who have been competing in similar events at this show and who have NOT won a ribbon on the day.

Hunters: For definitions, classification and guidelines on show hunters please refer to the website:

www.hunterhorses.com.au

RING 1 SHOW HUNTERS

Note that additional classes may be added on the day if sufficient horses are presented

RIDDEN SHOW HUNTER PONIES

101. Novice Show Hunter Pony ne 14hh
102. Intermediate Show Hunter Pony
103. Open Show Hunter Pony ne 11.2hh
104. Open Show Hunter Pony over 11.2 & ne 12hh
105. Open Show Hunter Pony over 12 ne 12.2hh
106. Open Show Hunter Pony over 12.2hh ne 13hh
107. Open Show Hunter Pony over 13hh ne 13.2hh
108. Open Show Hunter Pony over 13.2hh ne 14hh
109. Open Show Hunter ne 12.2hh (must not have won a previous open class)
110. Open Show Hunter over 12.2hh and ne 14hh (must not have won a previous open class)
111. Adults Show Hunter Pony ne 14hh (cannot compete in Child's, rider must be 17 years & over)
112. Childs Show Hunter Pony ne 14hh (cannot compete in Adults, rider must be under 17 years)
113. AHHA Show Hunter Pony (to be reg with AHHA and a current member)

CHAMPION & RESERVE HUNTER PONY

RIDDEN SHOW HUNTER GALLOWAYS

114. Novice Show Hunter Galloway
115. Intermediate Show Hunter Galloway
116. Open Show Hunter Galloway over 14hh ne 14.2hh
117. Open Show Hunter Galloway over 14.2hh ne 15hh
118. Open Show Hunter 14 – 15hh (must not have won a previous open class)
119. Adults Show Hunter Galloway ne 15hh (cannot compete in Child's, rider must be 17 years & over)
120. Childs Show Hunter Galloway ne 15hh (cannot compete in Adults, rider must be under 17 years)
121. AHHA Show Hunter Hack (to be reg with AHHA and a current member)

CHAMPION & RESERVE HUNTER GALLOWAY

RIDDEN SHOW HUNTER HORSES

122. Novice Show Hunter
123. Intermediate Show Hunter
124. Open Show Hunter over 15hh & ne 15.2hh
125. Open Show Hunter over 15.2hh & ne 16hh
126. Open Show Hunter over 16hh & ne 16.2hh
127. Open Show Hunter over 16.2hh
128. Open Show Hunter 15 – 16hh (must not have won a previous open class)
129. Open Show Hunter over 16hh (must not have won a previous open class)
130. Adult's Show Hunter (cannot compete in Child's, rider must be 17 years & over)
131. Child's Show Hunter (cannot compete in Adults, rider must be under 17 years)
132. AHHA Show Hunter Hack (to be reg with AHHA and a current member)

CHAMPION & RESERVE HUNTER HORSE

SUPREME SHOW HUNTER

RING 2 SENIOR RIDERS, GALLOWAY HACKS, 2ND CHANCE PONY HACKS, AUST RIDING PONIES

Note that additional classes may be added on the day if sufficient horses are presented

SENIOR RIDERS

- 201. Novice Rider 13 & under 17 years
- 202. District Rider 13 & under 17 years
- 203. Rider 13 & under 15 years
- 204. Rider 15 years & under 17 years
- 205. CHAMPION & RESERVE SENIOR RIDER

GALLOWAYS

- 206. Novice Galloway over 14 & ne 15hh
- 207. District Galloway over 14 & ne 15hh
- 208. Intermediate Galloway over 14 & ne 14.2hh
- 209. Intermediate Galloway over 14.2 & ne 15hh
- 210. Lightweight Galloway over 14 & ne 14.2hh
- 211. Heavyweight Galloway over 14 & ne 14.2hh
- 212. Lightweight Galloway over 14.2 & ne 15hh
- 213. Heavyweight Galloway over 14.2 & ne 15hh
- 214. Open Galloway over 14 & ne 14.2hh (Must not have won an previous open Galloway Class)
- 215. Open Galloway over 14.2hh ne 15hh (Must not have won a previous open Galloway Class)
- 216. Child's Galloway 14 – 15hh (cannot compete in Adults, rider must be under 17 years)
- 217. Adult's Galloway 14 – 15hh (cannot compete in Child's, rider must be 17 years & over)

CHAMPION & RESERVE SMALL GALLOWAY
CHAMPION & RESERVE LARGE GALLOWAY

SUPREME RIDER OF SHOW

SUPREME RIDER

*to be judged in Ring 3
at the conclusion of Adult / Senior / Junior classes*

SUPREME HACK OF SHOW

*to be judged in Ring 3 at the conclusion of Pony/
Galloway/ Hack classes.*

**COME TO THE
CASTLE HILL 2019
ANNUAL HORSE SHOW**

**SAT & SUN
23 & 24 MARCH 2019**

#

2nd CHANCE PONY HACK CLASSES

To enter second chance classes Ponies must not have already won a 1st place in an Open Class

- 218. Open Pony n/e 12h
- 219. Open Pony over 12h & n/e 12.2h
- 220. Open Pony over 12.2h & n/e 13h
- 221. Open Pony over 13h & n/e 13.2h

- 222. Open Pony over 13.2h & n/e 14h

AUSTRALIAN RIDING PONIES

LED AUSTRALIAN RIDING PONIES

- 223. Led Yearling
- 224. Led Colt 2 & 3yo
- 225. Led Filly 2 & 3yo
- 226. Led Gelding 2 & 3yo
- CHAMPION & RESERVE JUNIOR LED RPSB

- 227. Led Stallion 4 yo and over
- 228. Led Mare 4yo and over, ne 12.2hh
- 229. Led Mare 4yo and over, over 12.2hh & ne 13hh
- 230. Led Mare 4 yo and over, over 13hh & ne 14.2hh
- 231. Led Gelding 4yo and over, ne 12.2hh
- 232. Led Gelding 4yo & over, over 12.2 & ne 13hh
- 233. Led Gelding 4yo & over, over 13 & ne 14.2hh
- CHAMPION & RESERVE SENIOR LED RPSB

SUPREME LED RPSB

RIDDEN AUSTRALIAN RIDING PONIES

- 234. Ridden Stallion or Colt ne 14.2h
- 235. Ridden Mare or Gelding ne 12.2h
- 236. Ridden Mare or Gelding over 12.2 & ne 13.2h
- 237. Ridden Mare or Gelding over 13.2 & ne 14.2h
- 238. Ridden Riding Pony Junior Rider 17yo & under
- CHAMPION & RESERVE RIDDEN RPSB

SECOND CHANCE SHOW HUNTER

To enter must not have already won a 1st place in an Open Hunter Class

- 239. Open Show Hunter over 15hh & ne 16hh
- 240. Open Show Hunter over 16hh
- 241. Open SH Galloway over 14hh & ne 14.2hh
- 242. Open SH Galloway over 14.2hh & ne 15hh
- 243. Open SH Pony ne 12hh
- 244. Open SH Pony 12hh & ne 13hh
- 245. Open SH Pony 13hh & ne 14hh

**RING 3 ADULT RIDERS, HACKS, 2ND
CHANCE GALLOWAYS, ANSA,
THOROUGHBRED**

**Note that additional classes may be added on
the day if sufficient horses are presented**

ADULT RIDER CLASSES

- 301. Novice Adult Rider
 - 302. District Adult Rider
 - 303. Rider 17 years & under 21 years
 - 304. Rider 21 years & under 40 years
 - 305. Rider 40 years & over
- CHAMPION & RESERVE ADULT RIDER

HACKS

- 306. Novice Hack
 - 307. District Hack
 - 308. Intermediate Hack over 15hh & ne 16hh
 - 309. Intermediate Hack over 16hh
 - 310. Open Hack over 15hh & ne 15.2hh
 - 311. Open Hack over 15.2hh & ne 16hh
 - 312. Open Hack over 16hh & ne 16.2hh
 - 313. Open Hack over 16.2hh
 - 314. Open Hack 15hh – 16hh (must not have won a previous open class)
 - 315. Open Hack over 16hh (must not have won a previous open class)
 - 316. Child's Hack (cannot compete in Adult Hack, rider must be under 17 years)
 - 317. Adult's Hack (cannot compete in Child's Hack, rider must be 17 years & over)
- CHAMPION & RESERVE SMALL HACK

CHAMPION & RESERVE LARGE HACK

SUPREME RIDER OF SHOW

SUPREME RIDER
to be judged in Ring 3
at the conclusion of Adult / Senior / Junior classes

SUPREME HACK OF SHOW

*to be judged in Ring 3 at the conclusion of Pony/
Galloway/ Hack classes.*

2ndCHANCE GALLOWAY CLASSES

To enter in second chance classes Galloways must not have already won a 1st place in a previous Open Class

- 318. Open LW Galloway 14 – 14.2hh
- 319. Open HW Galloway 14 – 14.2hh
- 320. Open LW Galloway 14.2 – 15hh
- 321. Open HW Galloway 14.2hh – 15hh

AUSTRALIAN NATIONAL SADDLEHORSE

LED JUNIOR ANSA

- 322. Led Yearling
 - 323. Led Colt 2 & 3 years
 - 324. Led Filly 2 & 3 years
 - 325. Gelding 2 & 3 years
- CHAMPION & RESERVE LED JUNIOR ANSA

LED SENIOR ANSA

- 326. Stallion 4 yo & over
 - 327. Mare 4 yo & over, over 14h & ne 15.2hh
 - 328. Mare 4 yo & over, over 15.2hh
 - 329. Gelding 4 years & over, over 14hh & ne 15.2hh
 - 330. Gelding 4 yo & over, over 15.2hh
- CHAMPION & RESERVE LED SENIOR ANSA

SUPREME LED ANSA

THOROUGHBRED

LED THOROUGHBRED

- 331. Led TB Stallion/Colt
 - 332. Led TB Mare/ Filly
 - 333. Led TB Gelding
- CHAMPION & RESERVE LED TB

RIDDEN ANSA

- 334. Novice Ridden ANSA
 - 335. Open Ridden ANSA over 14hh & ne 15hh
 - 336. Open Ridden ANSA over 15hh & ne 16hh
 - 337. Open Ridden ANSA over 16hh
 - 338. Open ANSA Junior Rider 17yo & over
- CHAMPION & RESERVE RIDDEN ANSA

RIDDEN THOROUGHBRED

- 339. Ridden Thoroughbred

**COME TO THE
CASTLE HILL 2019
ANNUAL HORSE SHOW**

**SAT & SUN
23 & 24 MARCH 2019**

RING 4

JUNIOR RIDERS, PONY HACKS, 2ND CHANCE HACKS, AUSTRALIAN SADDLE PONIES

Note that additional classes may be added on the day if sufficient horses are presented

JUNIOR RIDERS

401. Tiny tots under 6 years (must be led by an adult)
 402. Novice Rider under 13 years
 403. District Rider under 13 years
 404. Rider 6 years & under 9 years
 405. Rider 9 & under 11 years
 406. Rider 11 & under 13 years
- CHAMPION & RESERVE JUNIOR RIDER

PONY HACKS

407. Novice Pony
 408. District Pony
 409. Intermediate Pony under 12.2h
 410. Intermediate Pony over 12.2h & ne 14h
 411. Open Pony ne 11.2h
 412. Open Pony over 11.2h & ne 12.2h
 413. Open Pony over 12.2h & ne 13h
 414. Open Pony over 13h & ne 13.2h
 415. Open Pony over 13.2h & ne 14h
 416. Open Pony ne 12.2hh (must not have won a previous open class)
 417. Open Pony 12.2hh – 14hh (must not have on a previous open class)
 418. Child's Pony - Rider under 13yo (cannot compete in Adults or other Child's class)
 419. Childs Pony - Rider 13yo – 17yo (cannot compete in Adults or other Child's class)
 420. Adult's Pony (cannot compete in Child's, rider must be 17 years & over)
- CHAMPION & RESERVE SMALL PONY HACK
CHAMPION & RESERVE LARGE PONY HACK

SUPREME RIDER OF SHOW

SUPREME RIDER

to be judged in Ring 3

at the conclusion of Adult / Senior / Junior classes

SUPREME HACK OF SHOW

*to be judged in Ring 3 at the conclusion of Pony/
Galloway/ Hack classes.*

2nd CHANCE HACK CLASSES

To enter in second chance classes horses must not have already won a 1st place in a previous Open Class

421. Open Hack over 15hh & ne 15.2hh
422. Open Hack over 15.2hh & 16hh
423. Open Hack over 16hh & ne 16.2hh
424. Open Hack over 16.2hh

AUSTRALIAN SADDLE PONIES

LED AUSTRALIAN SADDLE PONY

425. Stallion/ Colt
 426. Filly 3 years and under
 427. Gelding 3 years and under
 428. Mare 4 years and over ne 13hh
 429. Mare 4 over years, over 13hh – ne 14.2hh
 430. Gelding 4 years and over ne 13hh
 431. Gelding over 4 years , over 13hh – ne 14.2hh
- CHAMPION & RESERVE LED ASPA

RIDDEN AUSTRALIAN SADDLE PONY

432. Stallion Under Saddle
 433. Mare Under Saddle ne 13hh
 434. Mare Under Saddle over 13hh and ne 14.2hh
 435. Gelding Under Saddle ne 13hh
 436. Gelding Under Saddle over 13hh & ne 14.2hh
 437. Ridden ASPA Junior Rider 17yo & under
- CHAMPION & RESERVE RIDDEN ASPA

Drug Testing may be carried out at this show. Any breaches of the Rules & Regulations will be investigated by the Sub-Committee and offenders will be dealt with by the ASC Disputes/Disciplinary Sub-Committee.

If you are available to Steward on any days of the Castle Hill Show, please ring 9634 2632

RING 5

PART WELSH & WELSH PONIES, SHETLAND PONIES, AUSTRALIAN STUD BOOK PONIES, PARTBRED APSB/APSB RIDING PONIES

**Note that additional classes may be added on
the day if sufficient horses are presented**

*Proudly sponsored by
NSW EASTERN RPG
WELSH GROUP*



WELSH SECTION A

- 500. Led Section A Foal
- 501. Led Yearling Colt
- 502. Led Colt 2-3yrs
- 503. Led Stallion 4yo & over

CHAMPION & RESERVE COLT/STALLION

- 504. Led Yearling filly
- 505. Led Filly 2-3 yrs
- 506. Led Mare 4 yrs and over
- 507. Led Broodmare

CHAMPION & RESERVE FILLY/MARE

- 508. Led Yearling Gelding
- 509. Led Gelding 2-3 yrs
- 510. Led Gelding 4yrs and over

CHAMPION & RESERVE LED GELDING

WELSH SECTION B

- 511. Led Section B Foal
- 512. Led Yearling Colt
- 513. Led Colt 2 & 3 yrs
- 514. Led Stallion 4 yrs & over

CHAMPION & RESERVE COLT/STALLION

- 515. Led Yearling Filly
- 516. Led Filly 2-3 yrs
- 517. Led Mare 4 yrs and over
- 518. Led Broodmare

CHAMPION & RESERVE FILLY/MARE

- 519. Led Yearling Gelding
- 520. Led Gelding 2-3 yrs
- 521. Led Gelding 4 yrs and over

CHAMPION & RESERVE LED GELDING

WELSH SECTION C

- 522. Led Yearling any sex
- 523. Led Stallion or Colt
- 524. Led Filly 2 & 3 yrs
- 525. Led Mare 4 yrs and over
- 526. Led Gelding under 4 yrs
- 527. Led Gelding 4 yrs and over

CHAMPION & RESERVE LED SECTION C

WELSH SECTION D

- 528. Led Yearling any sex
- 529. Led Stallion or Colt
- 530. Led Filly 2 & 3 yrs
- 531. Led Mare 4 yrs and over
- 532. Led Gelding under 4 yrs
- 533. Led Gelding 4 yrs and over

CHAMPION & RESERVE LED SECTION D

SUPREME LED WELSH EXHIBIT

PART WELSH LED

- 534. Led Colt Under 4yrs
 - 535. Led Stallion 4yo & over
- #### **CHAMPION & RES PART WELSH COLT/STALLION**
- 536. Led Filly 3 yrs & under
 - 537. Mare 4 yrs and over ne 13hh
 - 538. Mare 4 yrs and over, over 13hh
- #### **CHAMPION & RESERVE PART WELSH MARE**
- 539. Gelding 3 yrs & under
 - 540. Gelding 4 yrs and over ne 13hh
 - 541. Gelding 4 yrs and over, over 13hh
- #### **CHAMPION & RESERVE PART WELSH GELDING**

SUPREME PART WELSH EXHIBIT

LED AUSTRALIAN STUD BOOK PONIES

- 542. Led Yearling Colt
 - 543. Led Colt 2-3 yrs
 - 544. Led Stallion 4yo & over
 - 545. Led Yearling Filly
 - 546. Led Filly 2-3 yrs
 - 547. Led Mare 4yo & over
 - 548. Led Yearling Gelding
 - 549. Led Gelding 2-3 yrs
 - 550. Led Gelding 4yo and over
- #### **CHAMPION & RES AUSTRALIAN PONY**

LED PARTBRED APSB/APSB RIDING PONY

- 551. Led Colt 3yo and under
 - 552. Led Stallion 4yo & over
 - 553. Led Filly 3yo and under
 - 554. Led Mare 4yo & over
 - 555. Led Gelding 3yo and under
 - 556. Led Gelding 4yo and over
- #### **CHAMPION & RESERVE PB APSB**

RIDDEN WELSH SECTION A/B/C/D

- 557. Stallion A/B/C/D
 - 558. Section A Mare
 - 559. Section B Mare
 - 560. Section C/D Mare
 - 561. Section A Gelding
 - 562. Section B Gelding
 - 563. Section C/D Gelding
- #### **CHAMPION & RESERVE RIDDEN WELSH**

RIDDEN PART WELSH

- 564. Stallion
 - 565. Gelding ne 13h
 - 566. Gelding over 13h
 - 567. Mare ne 13h
 - 568. Mare over 13h
- #### **CHAMPION & RESERVE RIDDEN PART WELSH**

RIDDEN AUSTRALIAN PONIES

- 569. Ridden Stallion/ Colt
 - 570. Ridden Mare
 - 571. Ridden Gelding
- #### **CHAMPION & RESERVE RIDDEN AUST PONY**

RING 5 cont.

RIDDEN PARTBRED APSB/APSB RIDING PONY

- 572. Ridden Stallion/ Colt
 - 573. Ridden Mare/ Gelding ne 13hh
 - 574. Ridden Mare/ Gelding over 13hh ne 14hh
 - 575. Ridden Mare/ Gelding over 14hh ne 14.2hh
- CHAMPION & RESERVE RIDDEN PARTBRED AUSTRALIAN PONY

SHETLAND PONIES

- 576. Led Yearling any sex
 - 577. Led Colt 2-3 yrs
 - 578. Led Stallion 4yo and over
 - 579. Led Filly 2-3 yrs
 - 580. Led Mare 4yo & over
 - 581. Led Gelding 2-3 yrs
 - 582. Led Gelding 4 yo & over
- CHAMPION & RESERVE LED SHETLAND PONY

RIDDEN SHETLAND PONIES

- 583. Ridden Stallion/Colt
- 584. Ridden Mare/Filly
- 585. Ridden Gelding

Castle Hill Twilight Show is
"B" Class
For Pure Bred Arabians &
Arabian Derivatives

COME TO THE
CASTLE HILL 2019
ANNUAL HORSE SHOW

SAT & SUN
23 & 24 MARCH 2019

**RING 6
PUREBRED ARABIANS, ARABIAN
DERIVATIVES**

**Note that additional classes may be added on
the day if sufficient horses are presented**

PUREBRED ARABIANS

LED PUREBRED ARABIANS

- 601. Best Head
 - 602. Best Trot
 - 603. Led Yearling Colt/Gelding
 - 604. Led Colt/Gelding 2 & 3yo
 - 605. Led Stallion/Gelding 4yo & over
- CHAMPION & RES LED STALLION/GELDING
- 606. Led Yearling Filly
 - 607. Led Filly 2 & 3yo
 - 608. Led Mare 4yo & over
- CHAMPION & RESERVE LED MARE

ARABIAN DERIVATIVES

LED ARABIAN DERIVATIVES

- 609. Best Head Arabian Derivative
 - 610. Best Trot Arabian Derivative
 - 611. Arabian Derivative Yearling Colt
 - 612. Arabian Derivative Colt 2 & 3 yrs
 - 613. Arabian Derivative Stallion 4 yrs & over, ne 14hh
 - 614. Arabian Derivative Stallion 4 yrs & over, over 14hh & n/e 15hh
 - 615. Arabian Derivative Stallion 4 yrs & over, over 15hh
- CHAMPION AND RESERVE STALLION/COLT
- 616. Arabian Derivative Foal any sex (not eligible for Champion)
 - 617. Arabian Derivative Brood mare (see definition)
 - 618. Arabian Derivative Yearling Filly
 - 619. Arabian Derivative Filly 2 years
 - 620. Arabian Derivative Filly 3 years
 - 621. Arabian Derivative Mare 4yrs & over, n/e 13hh
 - 622. Arabian Derivative Mare 4yrs & over, over 13hh & n/e 14hh
 - 623. Arabian Derivative Mare 4yrs & over, 14hh & n/e 15hh
 - 624. Arabian Derivative Mare 4yrs & over, over 15hh
- CHAMPION AND RESERVE LED MARE/FILLY
- 625. Arabian Derivative Yearling Gelding
 - 626. Arabian Derivative Gelding 2 & 3 years
 - 627. Arabian Derivative Gelding 4 years & over n/e 13hh

RING 6 cont.

628. Arabian Derivative Gelding 4yrs & over, over 13hh & n/e 14hh
 629. Arabian Derivative Gelding 4yrs & over, over 14hh & n/e 15hh
 630. Arabian Derivative Gelding 4yrs & over, over 15hh

CHAMPION AND RESERVE LED GELDING

SUPREME LED ARABIAN DERIVATIVE

631. Junior Handler under 18 years

PURE BRED ARABIANS RIDDEN

632. Novice Ridden Arabian
 633. Intermediate Ridden Arabian
 634. Ridden Stallion
 635. Ridden Mare
 636. Ridden Gelding
- CHAMPION AND RESERVE PUREBRED RIDDEN ARABIAN

RIDDEN ARABIAN DERIVATIVES

637. Novice Ridden Derivative (any sex)
 638. Intermediate Ridden Derivative n/e 14hh
 639. Intermediate Ridden Derivative over 14hh & n/e 15hh
 640. Intermediate Ridden Derivative over 15hh
 641. Ridden Derivative Stallion
 642. Ridden Derivative Mare n/e 13hh
 643. Ridden Derivative Mare over 13hh & n/e 14hh
 644. Ridden Derivative Mare over 14hh & n/e 15hh
 645. Ridden Derivative Mare over 15hh
 646. Ridden Derivative Gelding n/e 13hh
 647. Ridden Derivative Gelding over 13hh & n/e 14hh
 648. Ridden Derivative Gelding over 14hh & n/e 15hh
 649. Ridden Derivative Gelding over 15hh
- CHAMP & RESERVE RIDDEN A/D NE 14HH
 CHAMP & RESERVE RIDDEN A/D OVER 14HH

SUPREME RIDDEN ARABIAN DERIVATIVE

The following classes are open to BOTH Arabians and Arabian Derivatives:

650. Bridle Path Hack n/e 15hh
 651. Bridle Path Over 15hh
 652. Pleasure Ridden
 653. Show Costume
 654. Native Costume

RING 7**BUCKSKINS, PALOMINOS, PINTOS, SMALL HORSES, MINIATURE PONIES & HORSES**

Note that additional classes may be added on the day if sufficient horses are presented

LED BUCKSKINS

Proudly sponsored by
BUCKSKIN HORSE ASSOCIATION - NSW

701. Best Presented
 702. Colt 3 years and under
 703. Stallion 4 yrs and over
 CHAMPION & RESERVE LED STALLION/COLT
 704. Yearling Filly
 705. Filly 2-3 years
 706. Mare 4 years & over ne 14hh
 707. Mare 4 yrs and over, over 14hh
 708. Broodmare
 CHAMPION & RESERVE BUCKSKIN MARE
 709. Yearling Gelding
 710. Gelding 2-3 years
 711. Gelding 4 years & over ne 14hh
 712. Gelding 4 yrs and over, over 14hh
 CHAMPION & RESERVE BUCKSKIN GELDING

SUPREME LED BUCKSKIN**LED ROAN HORSES & PONIES**

Proudly sponsored by
ROAN HORSE & PONY SOCIETY OF AUST.

713. Led Yearling any sex
 714. Led Filly 2-3yrs
 715. Led Colt/ Gelding 2-3yrs
 716. Led Stallion 4yrs and over
 717. Led Mare 4 yrs and over
 718. Led Gelding 4yrs and over

CHAMPION & RESERVE LED ROAN HORSE & PONY SOCIETY OF AUSTRALIA INC

LED PALOMINOS

No false tails are permitted in any Palomino classes.

719. Best Presented
 720. Best Mane & Tail
 721. Best Coat Colour
 722. Colt 3 years and under
 723. Stallion 4 yrs and over
 CHAMPION & RESERVE STALLION/ COLT
 724. Yearling Filly
 725. Filly 2-3 yrs
 726. Mare 4 years & over ne 14hh
 727. Mare 4 yrs and over, over 14hh
 728. Broodmare
 CHAMPION & RESERVE PALOMINO MARE/FILLY
 729. Yearling Gelding
 730. Gelding 2-3 yrs
 731. Gelding 4 years & over ne 14hh
 732. Gelding 4 yrs and over, over 14hh
 CHAMPION & RESERVE PALOMINO GELDING

SUPREME LED PALOMINO

RING 7 cont.

LED CREMELLOS/PERLINOS

733. Led Filly/ Gelding 3yrs and under
734. Stallion/ Colt
735. Led Mare 4 yrs and over
736. Led Gelding 4yrs and over
CHAMPION & RESERVE LED
CREMELLO/PERLINO

LED PINTOS

737. Best Presented
738. Best Marked
739. Colt 3 years and under
740. Stallion 4 yrs and over
CHAMPION & RESERVE PINTO STALLION/
COLT

741. Yearling Filly
742. Filly 2-3 yrs
743. Mare 4 years & over ne 14hh
744. Mare 4 yrs and over, over 14hh
CHAMPION & RESERVE PINTO MARE

745. Yearling Gelding
746. Gelding 2 - 3 years
747. Gelding 4 years & over ne 14hh
748. Gelding 4 yrs and over, over 14hh
CHAMPION & RESERVE PINTO GELDING

SUPREME LED PINTO

RIDDEN BUCKSKINS

749. Stallion/ Colt Under Saddle
750. Mare Under Saddle
751. Gelding Under Saddle
CHAMPION & RESERVE RIDDEN BUCKSKIN

RIDDEN ROAN

752. Ridden Roan, any sex

RIDDEN PALOMINOS

753. Stallion/ Colt Under Saddle
754. Mare Under Saddle
755. Gelding Under Saddle
CHAMPION & RESERVE RIDDEN PALOMINO

RIDDEN CREMELLO/PERLINO

756. Ridden Cremello/Perlino, any sex

RIDDEN PINTOS

757. Stallion/ Colt Under Saddle
758. Mare Under Saddle
759. Gelding Under Saddle
CHAMPION & RESERVE RIDDEN PINTO

AUST. MINIATURE PONIES ne 87cm

760. Best Presented
761. Best Coloured Exhibit
762. Led Yearling any sex
763. Led Colt 2-3yrs
764. Led Stallion 4yo and over
765. Led Filly 2-3yrs

766. Led Mare 4yo & over
767. Led Gelding 2-3yrs
768. Led Gelding 4 yo & over
CHAMPION & RES LED MINIATURE PONY

LITTLE HORSES over 38 " ne 42 "

769. Best Presented
770. Best Coloured exhibit
771. Led yearling any sex
772. Led Colt 2-3 yrs
773. Led Stallion 4yo and over
774. Led Filly 2-3 yrs
775. Led Mare 4yo & over
776. Led Gelding 2-3 yrs
777. Led Gelding 4 yo & over
CHAMPION & RESERVE LITTLE HORSE

SMALL HORSES ne 38 inches

778. Best Presented
779. Best Coloured Exhibit
780. Led yearling any sex
781. Led Colt 2-3 yrs
782. Led Stallion 4yo and over
783. Led Filly 2-3 yrs
784. Led Mare 4yo & over
785. Led Gelding 2-3 yrs
786. Led Gelding 4 yo & over
CHAMPION & RESERVE SMALL HORSE

MINIATURE HORSES ne 34 inches

787. Best Presented
788. Best Coloured Exhibit
789. Led Yearling any sex
790. Led Colt 2-3 yrs
791. Led Stallion 4yo and over
792. Led Filly 2-3 yrs
793. Led Mare 4yo & over
794. Led Gelding 2-3 yrs
795. Led Gelding 4 yo & over
CHAMPION & RES LED MINIATURE HORSE

JUNIOR HANDLERS

796. Open Junior Handler under 10yrs
797. Miniature Pony Junior Handler
798. Small Horse Junior Handler
799. Miniature Horse Junior Handler
800. Shetland Junior Handler
CHAMPION & RESERVE JUNIOR HANDLER



Thank you to Emma's Showhorses
for Promoting our event

RING 8**ANDALUSIAN, WARMBLOODS, FRIESIAN
WARMBLOOD, STANDARDBREDS, AUST
STOCKHORSES**

Note that additional classes may be added on
the day if sufficient horses are presented

LED WARMBLOODS

801. Led Stallion/Colt
802. Led Mare/Filly
803. Led Gelding
CHAMPION & RESERVE LED WARMBLOOD

**LED ANDALUSIANS – PUREBRED &
PARTBRED**

*Must be a current financial member and horses to
be registered with the Andalusian Horse
Association*

804. Best Presented
805. Led Stallion/Colt
806. Led Mare/Filly
807. Led Gelding
CHAMPION & RESERVE LED ANDALUSIAN

LED STANDARDBREDS

*Proudly Sponsored by the Standardbred Pleasure
and Performance Horse Association of NSW
(SPPA)*

808. Led Colt / Stallion
809. Led Filly 3 yrs and under
810. Led Mare 4 yrs old & over
811. Led Gelding under 6yrs old
812. Led Gelding 6yrs old & over
CHAMPION & RESERVE CHAMPION
LED STANDARDBRED

LED FRIESIAN – PUREBRED & PARTBRED

813. Best Presented
814. Led Stallion/Colt
815. Led Mare/Filly
816. Led Gelding
CHAMPION & RESERVE LED
FRIESIAN

LED HAFLINGERS

817. Best Presented
818. Led Stallion/Colt
819. Led Mare/Filly
820. Led Gelding
CHAMPION & RESERVE LED HAFLINGER

RIDDEN WARMBLOODS

821. Ridden Warmblood

RING 8 cont.**RIDDEN ANDALUSIANS**

822. Ridden Stallion
823. Ridden Mare
824. Ridden Gelding

RIDDEN STANDARDBREDS

825. Ridden Novice
826. Beginner Ridden Standardbred
827. Ridden Open
CHAMPION & RESERVE RIDDEN
STANDARDBRED

RIDDEN FRIESIAN

828. Ridden under 4 years
829. Ridden 4 years and over

RIDDEN HAFLINGERS

830. Ridden Haflinger

AUSTRALIAN STOCKHORSES

831. Led Yearling Filly
832. Led Filly 2 and 3 years
833. Mare 4 years & over ne 15h
834. Mare 4 years & over, over 15h
CHAMPION & RESERVE LED MARE/FILLY
835. Yearling Colt
836. Colt 2 and 3 years
837. Stallion 4 years & over ne 15hh
838. Stallion 4 years & over, over 15hh
CHAMPION & RESERVE LED STALLION/COLT
839. Led Yearling Gelding
840. Gelding 2 and 3 years
841. Gelding 4 years & over ne 15hh
842. Gelding 4 years & over, over 15hh
CHAMPION & RESERVE LED GELDING

SUPREME LED ASH**RIDDEN AUSTRALIAN STOCK HORSES**

843. ASH Hack Stallion
844. ASH Hack Mare ne 15hh
845. ASH Hack Mare over 15hh
846. ASH Hack Gelding ne 15hh
847. ASH Hack Gelding over 15hh
848. ASH Hack ne 15hh ridden in a curb bit
849. ASH hack over 15hh ridden in a curb bit
850. ASH Hack Junior Rider 17yo and under
851. ASH Hack Junior Hack 3 yrs & under
CHAMPION & RESERVE ASH HACK
852. ASH Stallion Working Class
853. ASH Mare Working Class
854. ASH Gelding Working Class
855. ASH Junior Rider Working Class 17yo & under
856. ASH Junior Working Stock Horse 3yrs & under

CHAMPION & RESERVE WORKING
STOCKHORSE

SUPREME RIDDEN ASH

**RING 9
BEGINNERS RING**

Riders may NOT compete in other rings (apart from LED breed classes).

Riders must choose between led beginner and beginner (unassisted). Unassisted beginners are to choose between walk/trot only and walk/trot and canter (one at a time), apart from beginner with best hands, best sitting trot and pony/horse most suitable for unassisted beginners, where all beginner riders are eligible. All classes are mounted including best presented.

Classes may be split should the number of entries warrant.

Riders in this ring may wear show gear, pony club uniform or smart riding clothes as an alternative.

901. Best presented Led beginner
902. Best presented Beginner (unassisted)
903. Pony/horse with the longest tail
904. Pony/horse with the shortest tail
905. Hairiest horse/pony
906. Pony/horse with smallest ears
907. Pony/horse with the biggest ears
908. Led Beginner rider under 6yrs (walk/trot only)

909. Led Beginner rider 6yrs & u 10yrs (walk/trot only)
910. Led Beginner over 10yrs (walk/trot only)
911. Led Beginner with best hands (walk/trot only)
912. Led Beginner with best sitting trot (walk/trot only)
913. Beginner under 8yrs (walk/trot only, unassisted)
914. Beginner 8yrs & u 12yrs (walk/trot only, unassisted)
915. Beginner rider over 12yrs (walk/trot, unassisted)

916. Beginner rider under 10yrs (walk/trot/canter, unassisted, one at a time)

917. Beginner rider 10yrs and over (walk/trot/canter, unassisted, one at a time)

918. Beginner with best hands (walk/trot only, unassisted)

919. Beginner rider with the best sitting trot (walk/trot only, unassisted)

CHAMPION BEGINNER RIDER

RESERVE CHAMPION BEGINNER RIDER

920. Leading rein miniature pony/shetland
921. Leading rein show pony under 12.2hh
922. Leading rein show hunter pony under 12.2hh
923. Leading rein show pony/hack over 12.2hh
924. Leading rein show hunter pony over 12.2hh
925. Pony most suitable for led beginners
926. Beginner miniature/Shetland (walk and trot only, unassisted)
927. Beginner pony ne 13hh (walk and trot only, unassisted)
928. Beginner horse over 13hh (walk and trot only, unassisted)
929. Beginner pony/horse (walk/trot and canter, unassisted, one at a time)
930. Pony/horse most suitable for unassisted beginners (walk/trot only)

**CHAMPION LEADING REIN/BEGINNER
PONY/HORSE**

**RESERVE CHAMPION LEADING
REIN/BEGINNER PONY/HORSE**

**COME TO THE
CASTLE HILL 2019
ANNUAL HORSE SHOW**

**SAT & SUNDAY
23 & 24 MARCH 2019**

**Proud Sponsors of the
2018 Castle Hill Twilight Horse Show**

We thank our sponsors for their support
and appreciate their generosity.

**Buckskin Horse
Association - NSW**
www.buckskinnsw.com

**Roan Horse & Pony
Society of Australia Inc**
www.roanhorsepony.com

Hills Hawkesbury Equestrian News
www.theequestriannews.com.au

Performa Ride
www.performaride.com.au

Jojubi Saddlery
www.jojubisaddlery.com.au

Standardbred Pleasure and Performance Horse Association of NSW (SPPA)
www.standardbred.org.au

NSW Eastern RPG Welsh Group



 Judges and Stewards parking

 Traffic light controlled entrance

 Ticket sales and stalls

 Exhibitor and general parking



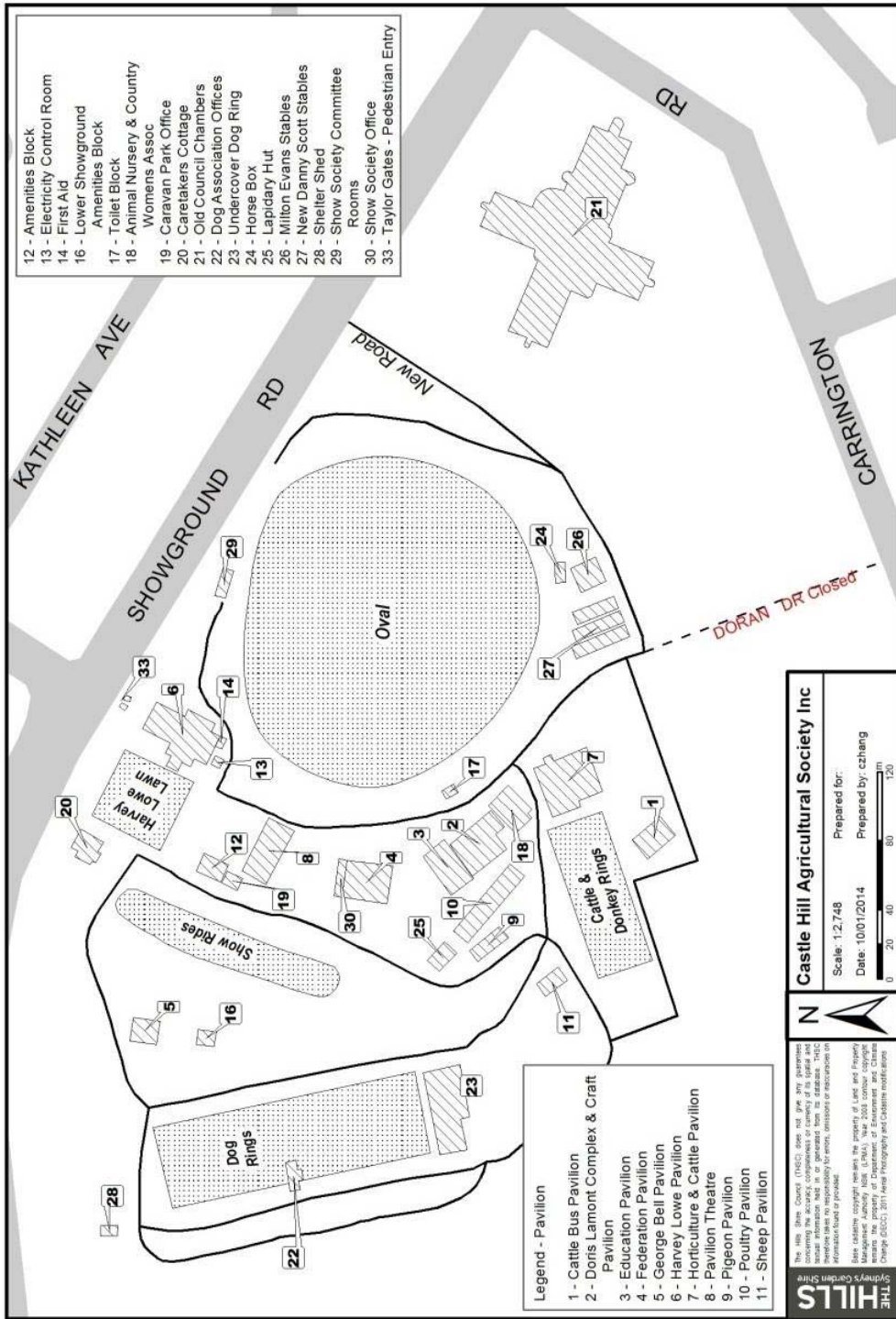

- 12 - Amenities Block
- 13 - Electricity Control Room
- 14 - First Aid
- 16 - Lower Showground Amenities Block
- 17 - Toilet Block
- 18 - Animal Nursery & Country Womens Assoc.
- 19 - Caravan Park Office
- 20 - Caretakers Cottage
- 21 - Old Council Chambers
- 22 - Dog Association Offices
- 23 - Undercover Dog Ring
- 24 - Horse Box
- 25 - Lapidary Hut
- 26 - Milton Evans Stables
- 27 - New Danny Scott Stables
- 28 - Shelter Shed
- 29 - Show Society Committee Rooms
- 30 - Show Society Office
- 33 - Taylor Gates - Pedestrian Entry

- Legend - Pavilion**
- 1 - Cattle Bus Pavilion
 - 2 - Doris Lamont Complex & Craft Pavilion
 - 3 - Education Pavilion
 - 4 - Federation Pavilion
 - 5 - George Bell Pavilion
 - 6 - Harvey Lowe Pavilion
 - 7 - Horticulture & Cattle Pavilion
 - 8 - Pavilion Theatre
 - 9 - Pigeon Pavilion
 - 10 - Poultry Pavilion
 - 11 - Sheep Pavilion

Castle Hill Agricultural Society Inc

Scale: 1:2,748 Prepared for:

Date: 10/01/2014 Prepared by: czhang

0 20 40 60 80 100

CASTLE HILL
Society's Crest on Silver

The Hills Shire Council (HSC) does not give any guarantee concerning the accuracy, completeness or currency of its digital and printed information. The Council is not responsible for any errors, omissions or inaccuracies in the information provided. Basic cadastre copyright remains the property of Land and Property Information, the property of Department of Environment and Climate Change (DECC). 2011 Aerial Photography and Cadastre maps are used.

JUDGES FOR CASTLE HILL 2018 TWILIGHT SHOW

Judge

(Correct at time of printing)

- | | |
|--|----------------------------|
| 1 Show Hunter Horses | Sharyn McKell |
| 2 Senior Riders Open Galloways, 2 nd Chance Pony Hacks and Australian Riding Ponies | Louise Doyle Ryan |
| 3 Adult Riders, Hacks, 2 nd Chance Galloways, ANSA and Thoroughbred | Jason Ryan |
| 4 Junior Riders, Pony Hacks, 2 nd Chance Hacks and Aust. Saddle Ponies | Jess Doyle |
| 5 Part Welsh & Welsh Ponies, Shetland Ponies, Australian Stud Book Ponies, Partbred APSB/APDB Riding Ponies | Sue Allfrey |
| 6 Pure Bred Arabians And Arabian Derivatives | Rosalie Mayo-Ramsay |
| 7 Buckskins, Palominos, Pintos, Small Horses, Miniature Ponies & Horses | Peter Cole |
| 8 Andalusian, Warmbloods, Friesian Warmblood, Standardbreds, Aust Stockhorses | Rozinda Clare |
| 9 Beginners Ring | Natalie Ramsay |

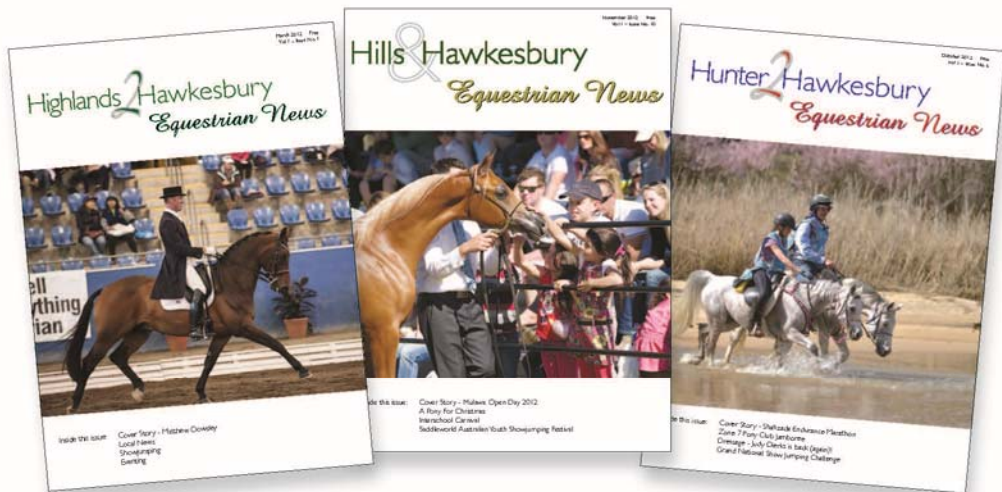

ADVERTISING & Editorial ENQUIRIES

Phone/Fax: 02 4572 8860 Mob: 0401 783 434

Email: hillshawkesburyequestriannews@mail.com

PO Box 237 Glenorie NSW 2157